

## 236 Conference Room

**Standard Set**

Open Space

**Capacity:**

2-6 people

**Area**

Square Feet

**Furniture**

Chairs:  
7 task chairs

Tables:  
1 conference table,  
1 credenza

**Built in Tech Equipment**

Conference Phone, Large 75"  
TV, Logitech Camera/  
Microphone, doorbell (for entry  
from hallway)

**Conference Room Phone**

206-221-8141

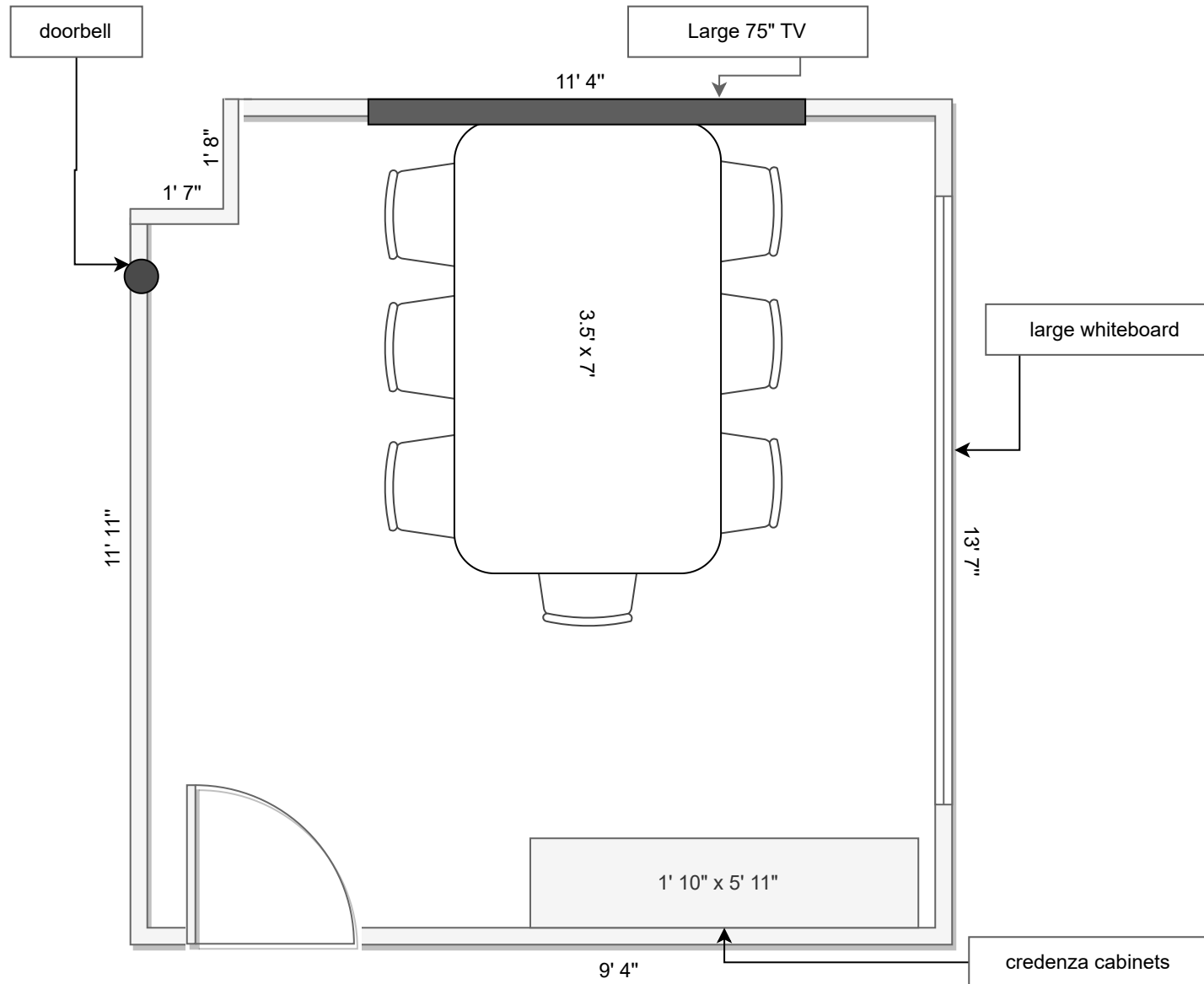

All components of the diagrams are subject to change. Illustrated diagrams and their components are estimations only. Additional furnishing (stacks of chairs / tables) not indicated on diagram may be present in the room at the time of your reservation. Please contact our office with any additional questions.